

Sold

SOLD! IN 6 DAYS!

3 Barbon Lane, Baldivis



SOLD SOLD SOLD! Perfect for those wanting to downsize, invest, or looking to buy their 1st home. But hurry, homes of this caliber do not last.

Perfectly positioned directly opposite a delightful park, this modern and well-maintained home is perfect for the kids or your family pet to have their daily walk.

Built with style, security, and convenience in mind, this home is the complete package and fantastic opportunity to create your very own low-maintenance, high-quality lifestyle.

On top of the 3 generous size bedrooms, this bright and airy floor plan also includes:

- Your very own theatre room, already set up for Foxtel streaming
- A supersized master bedroom suite that will fit a king-size

🛏 3 🚿 2 🚗 2 📺

323 m2

Price	SOLD
Property Type	Residential
Property ID	206
Land Area	323 m2
Floor Area	130.06 m2

Agent Details

Saskia Wrobluskie - 0477
726 849

Office Details

Advantas Property Group
Suite 13/3 Statesman
Parade Baldivis, WA, 6171
Australia
0895 680 960

bed with ease

- Ample entertainment space at both the front & rear of your property. Perfect if you do have pets and want to separate the two spaces.
- Beautiful timber decking to the rear, a perfect location for a spa
- Retractable shade sail over the timber decking
- Peace of mind for anyone who works away as this home is already set up with crimsafe security doors & windows throughout and a security camera to the rear
- Ducted air-conditioning throughout
- Stylish remote-controlled LED light/fan combo to the living, theatre, and master rooms
- NBN ready

Call Saskia on 0477 726 849 and book your inspection today!

The above information provided has been furnished to us by the vendor/s. We have not verified whether or not that information is accurate and do not have any belief in one way or the other in its accuracy. We do not accept any responsibility to any person for its accuracy and do no more than pass it on. All interested parties should make and rely upon their own inquiries in order to determine whether or not this information is in fact accurate.

SPRINKLED GAS POINT HAS BEEN INSTALLED ON THE BASIS OF ONLY BEING SUITABLE FOR A FLUED HEATER. NO HIGH OR LOW VENTILATION HAS BEEN BUILT INTO HOME TO TAKE AN UNFLUED UNIT

NOTE: (4) CORNER BEADS TO INTERNAL WALLS AS NOTED ON PLAN BY A CIRCLE

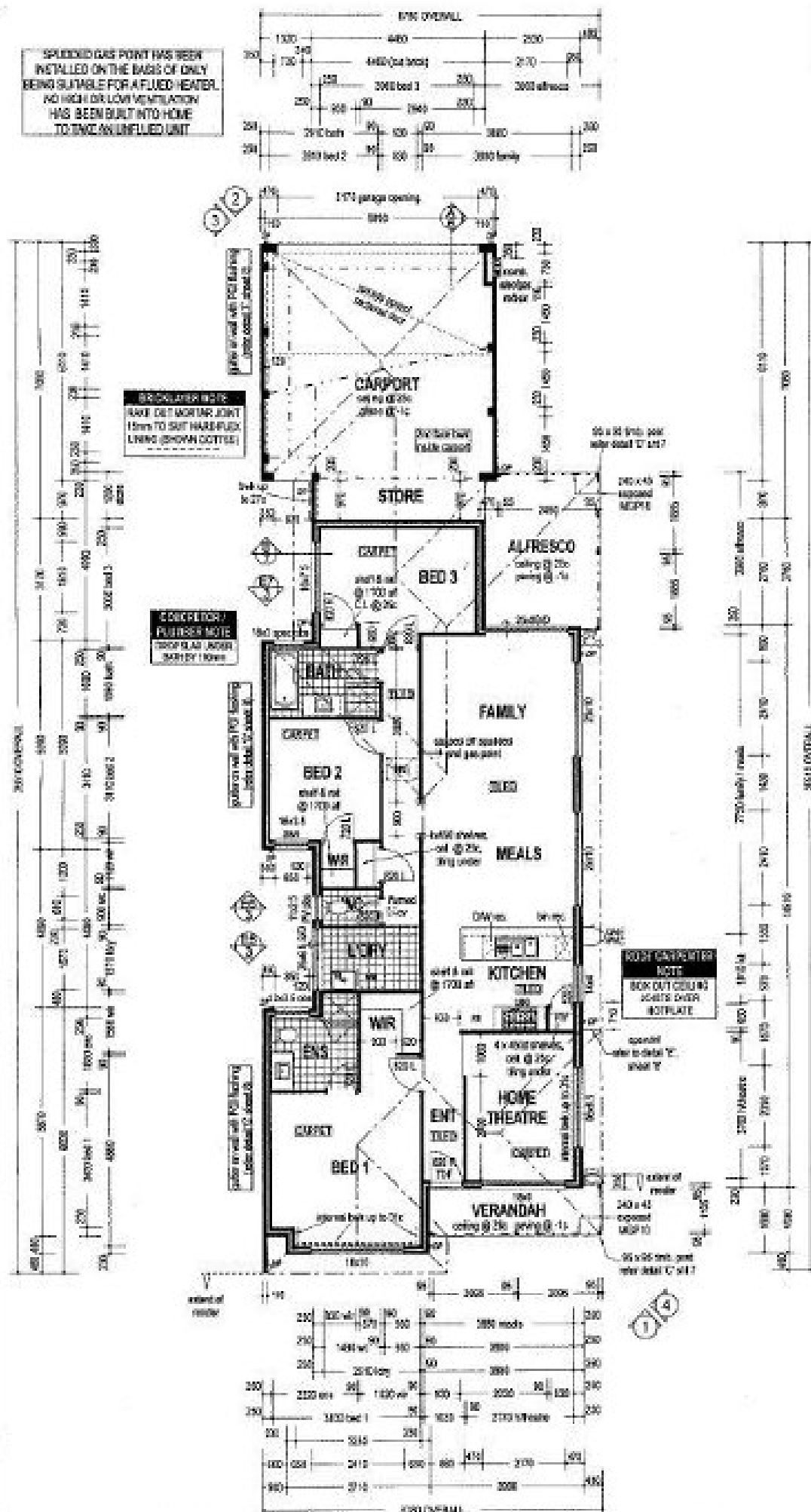

May 15

THESE RESERVES THE RIGHT TO ANY DIMENSIONS AND MATERIALS FROM THOSE ON THIS PLAN. PLEASE CHECK PLANS, SPECIFICATIONS AND ACCESSORIES CAREFULLY. ALL DIMENSIONS TO FACE UNLESS OTHERWISE NOTED. THE PLANS SHALL REMAIN THE SOLE PROPERTY OF THE DREAMSTART GROUP AND NOT BE GIVEN, LOANED, REPRODUCED OR OTHERWISE COPIED OR USED WITHOUT THE WRITTEN PERMISSION OF DREAMSTART GROUP.

Logic